

MegaPX Indoor IR Dome Camera

The **MegaPX Indoor IR Dome Camera** from March Networks® delivers megapixel image quality, combined with the efficiency of H.264 streams in real time, and the flexibility of True Day/Night (TDN). It incorporates a progressive scan CMOS sensor with Wide Dynamic Range (WDR), and 1080p resolution for excellent image quality, even in bright backlight situations. In addition, the camera's built-in IR technology allows you to discern objects in the dark, from distances of up to 65.5 feet (20m).



MEGAPIXEL IMAGES IN ADVERSE LIGHTING CONDITIONS

The camera's powerful combination of Wide Dynamic Range (WDR), True Day/Night (TDN) technology, and IR illumination, plus progressive scan in high resolution, delivers excellent image quality, even in bright backlight and near-dark conditions. In addition, the camera's Smart-IR technology ensures that images will not be overexposed or underexposed.

CLEAR VIDEO IN VIRTUAL DARKNESS

In situations where there is minimal to no ambient light, even a TDN camera will not provide a crystal-clear image. In order to compensate for this, the MegaPX Indoor IR Dome incorporates IR illuminators to light up even the darkest scenes (in as little as 0 lux), up to a distance of 65.5 feet (20m).

EASY TO INSTALL; EASY ON YOUR NETWORK

The dome's support for Power over Ethernet (PoE) allows for an easy installation without the burden of additional cables for power, providing substantial savings in installation time and costs. The camera's remote zoom/focus feature eliminates the need to adjust focal length and focus settings from the top of a ladder. You can zoom in on the scene and focus the camera with a simple mouse click. In addition, the camera supports H.264, the most efficient video compression technique available; it yields high video quality and frame rate at low bandwidth.

YOUR VIDEO IS ALWAYS AVAILABLE, EVEN WHEN YOUR NETWORK ISN'T

The camera has the ability to record to an internal microSDHC card or to a NAS device, providing redundant recording in the event of a network outage or server failure. When the camera is used with March Networks Command™ Recording Server or 8000 Series Hybrid NVR, an innovative Shadow Archive feature allows for seamless access to that recorded video, for total fail-safe management.

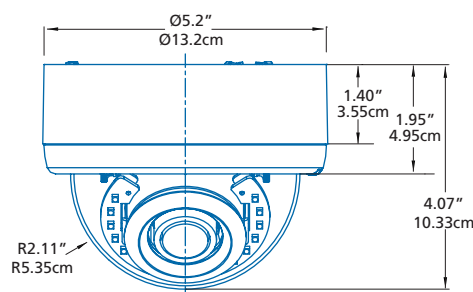

FEATURES

- 1/3" low-light progressive scan CMOS sensor
- True Day/Night (TDN) with removable IR cut filter
- Wide Dynamic Range (WDR)
- Motorized zoom lens for autofocus
- High-performance IR illuminators (20m illumination distance)
- Smart-IR technology means no image overexposure or underexposure
- 30 fps @ 1920x1080
- Up to 6 schedulable sensor profiles
- Recording on schedule and event
- Bi-directional audio
- Shadow Archiving™ with microSDHC card or NAS
- 2 alarms in / 1 relay out
- Active video tampering
- Power over Ethernet (PoE)
- Dual-streaming H.264 and MJPEG
- Surface mount, 3-axis adjustment

PART NUMBERS

CAMERA

- 30671 – MegaPX Indoor IR Dome Camera

MegaPX Indoor IR Dome Camera

CAMERA

Image Sensor	1/3" progressive scan CMOS
Lens	F1.2, f=3-9mm
Minimum Illumination	Color: 0.05 lux @ F1.2 (30IRE, AGC On) B/W: 0 lux @ F1.2 (IR On)
Wide Dynamic Range	72.4dB
Shutter Time	1 to 1/10000 s
Camera Angle Adjustment	Pan 340°, tilt 72°, rotation 340°
IR Wavelength	850nm
IR Illumination Distance	20m
Day/Night Functionality	Removable IR cut filter
Shutter	1/25s – 1/8000s
White Balance	Manual/Automatic

VIDEO

Video Compression	H.264 High profile / M-JPEG
Max Resolution	1920x1080
Optional Resolution	
Major Stream	1920 x 1080, 1280 x 1024, 1280 x 960, 1280 x 720, 1024 x 768, 800 x 600
Minor Stream	720 x 576, 720 x 480, 640 x 480, 352 x 288, 352 x 240
Frame Rate	30 fps @ 1920x1080
Video Streaming	Dual-stream H.264 and M-JPEG (full resolution on stream 1; maximum D1 on stream 2) Controllable frame rate and bandwidth CBR/VBR H.264; VBR M-JPEG (quality settings)
Image Settings	Wide Dynamic Range, anti-flicker, white balance mode, brightness, contrast, 3D Noise, exposure, saturation, hue, sharpness, auto day-night, mirror mode

AUDIO

Audio Streaming	Two-way
Audio Compression	G.711-u, PCM, G.726 ADPCM, configurable bit rate (8-48 kHz)
Audio Input/Output	Line input, line level output

NETWORK

Security	Password protection, IP address filtering, connection management, LDAP authentication, HTTPS encryption (configuration only)
Supported Protocols	ONVIF, NTP, RTP, RTSP, RTCP, HTTP, HTTPS, IPv4, TCP, UDP, DHCP, ARP, LDAP
Interface	10/100Mbps Ethernet (RJ-45)
Internet Browser	Internet Explorer (7.0+)
Network Delay	≤250ms

SYSTEM INTEGRATION

Alarms	2 alarm inputs, 1 relay output
Intelligent Video	Video motion detection (up to 4 areas), connection monitoring, active tampering
Alarm Triggers	Video motion detection, active tampering, external input
Alarm Events	External output activation, video recording to local storage (microSDHC Card), video recording to NAS

GENERAL

Housing	Light-weight, durable interior plastic housing with Polycarbonate transparent bubble
Power	Power over Ethernet (PoE) IEEE 802.3af Class 3; 12VDC/24VAC
Power Consumption	<9W
Connectors	RJ-45 100BASE-TX PoE; 1 alarm input; 1 alarm output; 3.5mm line in; 3.5mm line out
Local Storage (up to 32G)	microSDHC card slot (card not included)
Operating Conditions	32° to 104°F / 0° to 40°C; 0-90% RH (non-condensing)
Storage Temperature	-4° to 140°F / -20° to 60°C
Mechanical	
Weight	1.87 lbs / 0.85 kg
Dimensions (HxD)	4.07 x 5.20 in. / 10.33 x 13.2 cm
Mounting Options	Surface mount
Included Accessories	Software CD, screwdriver, screws, wall anchors, mounting template
Upgrade Online	Yes

REGULATORY

Regulatory Approvals	IEC622621, CE/EMC: EN 55022, EN 55024, EN 61000-3-32, FCC: PART 15 Subpart B ICES-003
-----------------------------	---