



As with all Pro series cameras, the Day & Night 1080P HD IR IP Camera IPR722-IVS incorporates Sense up+, a unique technology that successfully delivers stunning video in low-light conditions. Utilizing intelligent image signal processing, AGC control, and 3D Noise Reduction, Intelligent Video Surveillance, this model successfully delivers the ultimate low-light image without motion blur. The IPR722-IVS is capable of producing four independent video streams, different streams can be set for different applications, depending on the individual user requirements. The IP66-rated housing is designed to help the camera body withstand rain and dust and ensures operation under a multitude of harsh weather conditions.

FEATURES :

- Full HD 2 megapixel CMOS image sensor
- True H.264 AVC/MPEG-4 part 10 real-time Video compression
- H.264 and Motion JPEG multi-profile Video streaming
- 3D Noise Reduction (MCTF)
- 2D WDR function / Digital PTZ supported
- Intelligent Video Surveillance
- Face / tampering / motion detection
- High efficiency IR LED, Radiant distance up to 30m
- Day & Night (IR cut removable)
- ONVIF supported
- 2-way audio supported
- Digital I/O : 1 in, 1 out
- ONVIF supported

DIMENSIONS : (Unit : mm)

Body : 82(W) x 72.5(H) x 154(D) Bracket: 101(L)

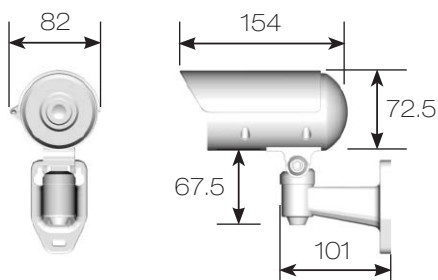

INSTALLATION HOLE SITE DIAGRAM :

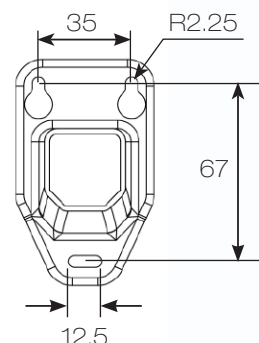

SPECIFICATION :

Name		Day & Night 1080P HD IR IP Camera	
Model		IPR722-IVS	
Lens	Focal length	4.3mm	
	Iris	F1.6	
	Angle of view	H	84°
		V	45.2°
D		100.6°	
Pick up element		1/2.8" CMOS image sensor	
Effective pixels		1984 (H) x 1105 (V) = 2,192,320 (pixel)	
Scanning system		Progressive scan	
Infrared cut filter		Auto / schedule / day (color) / night (mono)	
Min. illumination		0.03 Lux at F1.6 (Low light mode) / 0 Lux with IR LED on	
White balance		Auto / tungsten / indoor / fluorescents1 / fluorescents2 / outdoor1 / outdoor2	
Back light compensation		Off / on	
Electronic shutter		1/30(1/25)s - 1/8000s	
Sense up		Off / 1 frame / 2 frames / 3 frames / 7 frames	
Sense up +		Yes	
Auto gain control		36 dB variable gain	
3D Noise Reduction		Off / 1 - 32 selectable	
2D WDR		Off / Auto / x2 / x3 / x4	
Privacy masking		Off / on (4 zones)	
Image effects		Brightness, Contrast, Hue, Saturation, Sharpness, Mirror, Flip	
IP rating		IP66	
Window		Ø 65 heat resistant glass	
Infrared LED	Peak wavelength	850nm	
	Beam spread	30°	
	Radiant distance	30M	
Operating temperature		-40°C - +50°C (-40°F - 122°F)	
Dimension		Body : 82mm(W) x 72.5mm(H) x 154mm(D) Bracket : 101mm(L)	
Weight		600g	
Power supply		DC12V ±10% / PoE (IEEE 802.3af compliant)	
Power consumption		DC12V, 9W / PoE, 10.2W	

Network			
Video compression		H.264 , Motion JPEG	
Resolution		1080P(1920 x 1080), 720P(1280 x 720), D1(720 x 480), CIF(352 x 240)	
Multiple profile	Profile #1	H.264 : up to 30 FPS @ 1920 x 1080, MJPEG : up to 30 FPS @ 720 x 480	
	Profile #2	H.264 : up to 30 FPS @ 1280 x 720, MJPEG : up to 30 FPS @ 352 x 240	
	Profile #3	H.264 : up to 30 FPS @ 1920 x 1080, MJPEG : up to 30 FPS @ 1280 x 720	
	Profile #4	H.264 : up to 30 FPS @ 720 x 480, MJPEG : up to 15 FPS @ 1920 x 1080	
Video streaming		RTP/HTTP, RTP/TCP, RTP/UDP, Multicast	
Video bitrate	128Kbps - 8Mbps		
	Frame rate and bit rate controllable on-the-fly		
	VBR / CBR / GOP supported		
Security	Base64 HTTP encryption		
	Multiple user access levels with password protection		
	10 user accounts available		
Users	8 simultaneous users		
ePTZ & digital zoom	Yes, ROI is supported		
OSD	Text overlay for date, time, and camera name		
Intelligent Video Surveillance	Advanced Motion / Board Zone / Semaphore+Board Zone / Object Counting		
Alarm functions	Motion / tampering / face detection triggering recording into SD card Image upload over FTP and E-mail by face / tampering / motion detection		
CPU, memory	Embedded SoC ARM11, 528MHz, 256MB DDR2, 256MB flash memory		
Maintenance	Firmware update via HTTP		
	Firmware available at web site		
Network interface	10Mbps / 100Mbps Base-T, RJ-45		
PC requirement	OS : Windows 2000, Windows XP, Windows Vista, Windows 7, Windows 8		
	Browser : Windows Internet Explorer 6.0 or above		
	CPU : intel pentium 4 1.8GHz or above		
	RAM : 1GB or above, independent display card		
Network protocols	IPv4, IPv6, TCP, UDP, HTTP, SMTP, NTP, DDNS, UPnP, FTP, ARP, DHCP, PPPoE, DNS, RTSP, RTCP, Telnet, ICMP, IGMP, ONVIF Profile S, SNMP, SIP, Bonjour		
Mobile phone	iPhone, iPad, and Android support		
System integration	ONVIF & LILIN HTTP API		
Central management system	NAV 1.0 support		
Video display	LILIN Universal ActiveX & LILIN Java Applet		
OS	Embedded Linux 2.6.32		
SD card recording	Support Micro SD/SDHC card for circular recording (card is not included)		