

HEG14

GRAND ENVIRONMENTAL HOUSING



The HEG14 series are stylish and functionally designed camera enclosures with features such as snap-on sunshield and adjustable mounting track that allows for easy installation.

To insure proper camera/lens adjustment, the camera remains stationary when opening the housing for camera service.

They are constructed of die-cast and extruded aluminum with an epoxy powder-coating making them corrosion resistant. Weatherproofing and dustproofing are accomplished with durable neoprene end gaskets making the housings suitable for all indoor and outdoor applications.

These housings can accommodate 2/3", 1/2" and 1/3" CCD cameras with fixed focal length or large zoom lenses.

- Contemporary design
- Die-cast and extruded aluminum construction
- Adjustable mounting track
- Removable body for easy servicing
- Snap-on sunshield option
- Indoor/outdoor installations
- Epoxy powder coated for corrosion resistance
- Dustproof, IP66 weatherproofing
- Pre-assembled heater & blower models available
- Cost effective
- 2-year limited warranty



HEG14

TECHNICAL SPECIFICATIONS

MODELS

| | |
|-----------------|---|
| HEG14 | Indoor/outdoor enclosure for 2/3" 1/2" and 1/3" CCD cameras with fixed focal length lenses or large zoom lenses |
| HEG14-01 | Same as HEG14 except supplied with snap-on sunshield |
| HEG14-02 | Same as HEG14 except supplied with snap-on sunshield and 24V ac heater |
| HEG14-03 | Same as HEG14 except supplied with snap-on sunshield, 24V ac heater and 24V ac blower |

MECHANICAL

| | |
|--|---|
| Camera Mounting | Slotted camera sled |
| Max Camera Size: | |
| Accommodates Camera/Lens Combinations (Including BNC) up to: | |
| HEG14/HEG 14-01 | 5.5W x 3.3H x 14.4L in. |
| HEG14-02/HEG14-03 | 5.5W x 3.3H x 13.4L in. |
| Viewing Area: | |
| HEG14/HEG 14-01 | 3.7W x 3.2H in. |
| HEG14-02/HEG14-03 | 3.7W x 3.2H in. |
| Viewing Window | Clear 1/8" double density glass |
| Cable Entry | Two compression fittings on rear bottom |
| Dimensions | See drawings |
| Weight: | |
| HEG14 | 6.5 lbs (2.6kg) |
| HEG14-01/02/03 | 9.1 lbs (4.1kg) |

GENERAL

| | |
|--------------|------------------------------------|
| Construction | Extruded and die-cast aluminum |
| Finish | Almond color, epoxy powder coating |
| Environment | Indoor/outdoor |

OPTIONS

| | |
|-----------------|---|
| HEG14-SS | Snap-on sunshield for HEG14 |
| HEG14-HK | Thermostat controlled heater kit, 24V ac, 20W |
| HEG14-BK | Thermostat controlled blower kit for HEG14, 24V ac (Regulated to 24V ac), 3.4 Watts |

RECOMMENDED MOUNTS

| | |
|--------------|---|
| WB+BJ | Recommended heavy-duty wall-mount with integrated ball joint head, 12" long. Supports up to 55 lbs. |
| WBM | Medium-duty wall-mount with integrated ball joint head, 8" long. Supports up to 35 lbs. |
| CM5 | Ceiling "J" mount with integrated ball joint head, 15.4" long. Supports up to 40 lbs. |
| CMP | 20" extension for CM5 ceiling-mount |
| CP | Reinforcing plate adapter for WBM & WB+BJ, 5.1W x 6.3H in. |
| CW | Corner-mount adapter for WBM & WB+BJ |
| SFP | Pole-mount adapter for WBM & WB+BJ, Adjustable for 3" to 5.5" poles |

HEG14

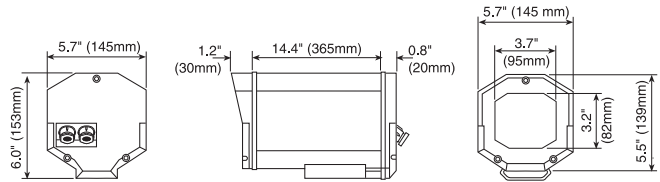

HEG14-BK (Blower Kit)

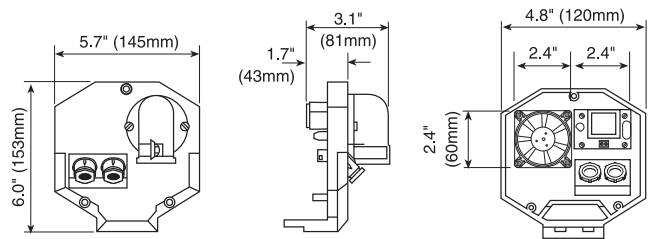

HEG14-SS (Sunshield)

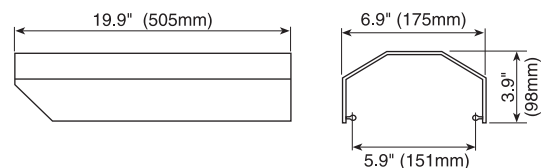

Design and specifications subject to change without notice.

Conversion: 1" = 25.4mm
Measurement conversions are approximate

Ultrak Worldwide Support Center:

1305 Waters Ridge Drive
Lewisville, TX 75057
(800) 796-2288 (972) 353-6500
Fax (972) 353-6670



www.ultrak.com