



## Mounts for Monitors

FDP-No. : 20011

### W-61

- For Wall Mounting
- Suitable for Monitors/TV Sets with Stable Cabinet
- High Load Capacity
- Easy to Turn and Tilt
- Lockable Tilt Angle
- TUEV/GS Approved
- Easy Installation



### Specifications:

Load capacity	75 kg
Vertical built-in height range	370-570 mm
Horizontal built-in height range	500-840 mm
Length of the wall bracket	550 mm
Colour	Black
Dimensions (HxWxD)	See drawing
Weight	14 kg

Accessories	
EDP No. / Type	Description
20070 BW-1	Mounting kit for W31/W41/W61/W71

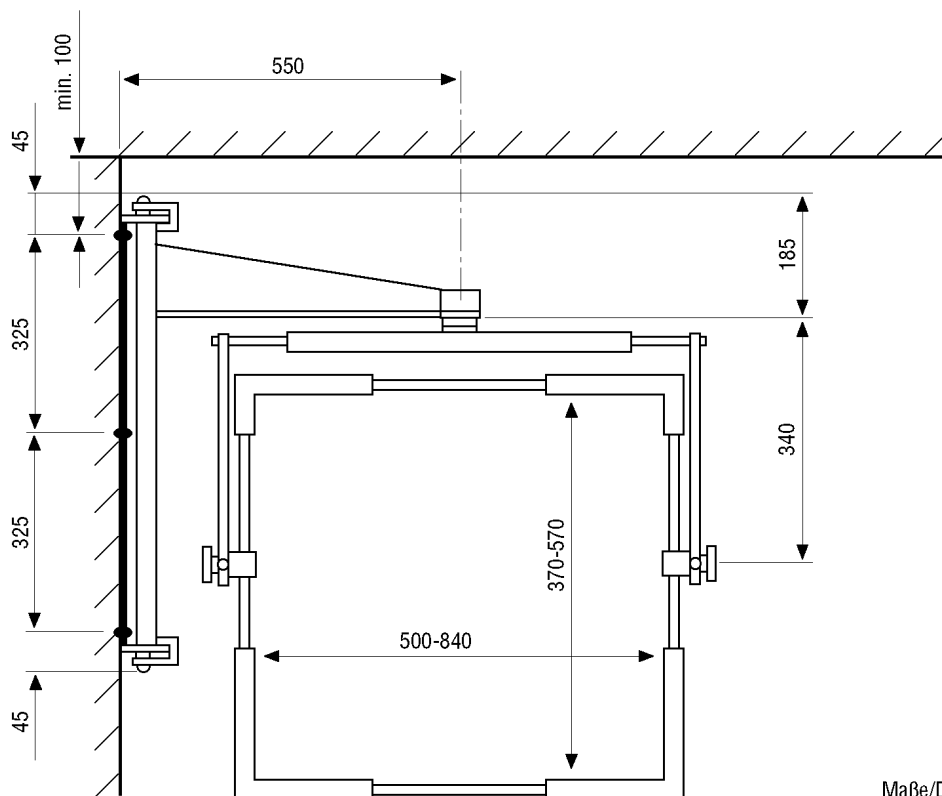

Maße/Dimensions: mm

e-mail: [info@eneo-security.com](mailto:info@eneo-security.com) • [www.eneo-security.com](http://www.eneo-security.com)