

Manual Lenses

EDP-No.: 43217

F04Z0310M

- Suitable for 1/3" and 1/4" Colour and B&W Cameras
- Variable Focal Length
- High Speed Lens
- High Resolution and Contrast
- CS Mount
- High Standard of Optical and Mechanical Quality
- For Use in Industrial and Security Sectors
- Lockable Focus and Zoom

No image available

Specifications:

Focal length (f)	3.5-10.5 mm
Aperture range (F)	F1.0-C
Mount	CS
Nominal format size	1/3"
Flange focal length	12.5 mm
Horizontal angle of view at nominal format size	81.6°-27.2°
Minimum object distance (M.O.D.)	0.3 m
Filter screw size	M37.5x0.5 mm
Screw-in depth	Colour: 5.4 mm; B&W: 8.5 mm
Dimensions (LxD)	See drawing
Weight	64 g
Remarks	Lockable focus and zoom ring

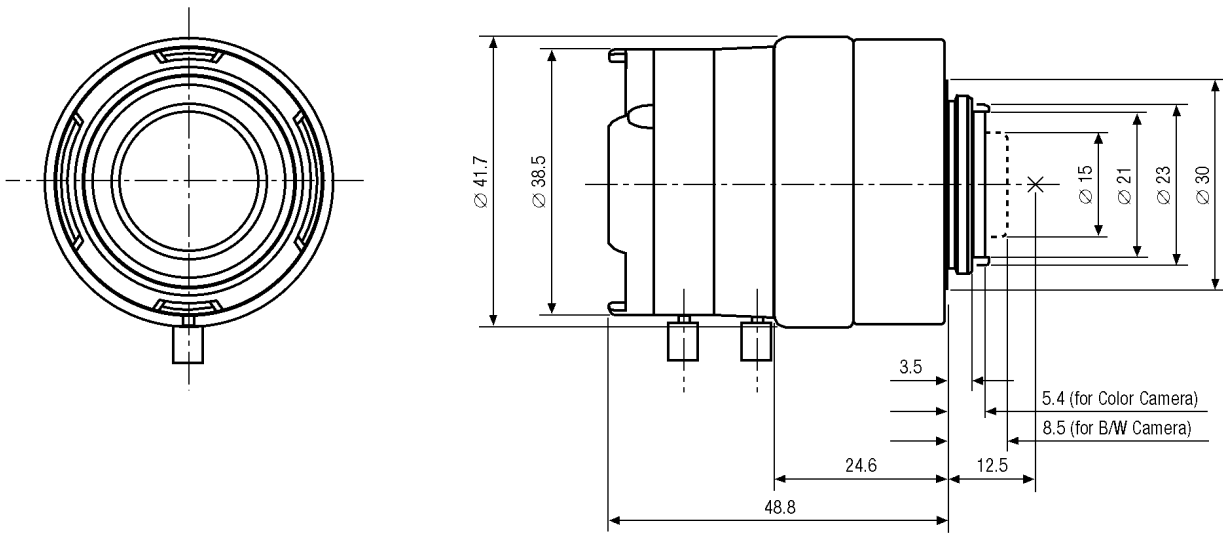

Maße/Dimensions: mm