



# DVR1C Series Digital Video Recorder



- ▶ Superior image and audio quality through digital recording
- ▶ Quick search by date/time, alarm events and recording list
- ▶ Easy jog/shuttle playback control
- ▶ Built-in display
- ▶ Export pictures and clips to Compact Flash cards
- ▶ Uninterrupted recording for one week or longer
- ▶ Remote viewing of recordings and live pictures via Web browser

The DVR1C1161 digital video recorder is the ideal and logical replacement for analog video recorders in CCTV systems. There is no need for costly and frequent maintenance, nor are there any videotapes to change and store. And, being digital, it offers many advanced recording and playback features, as well as continuous or time-lapse recording for up to a week or longer.

The DVR1C can connect directly to a single camera, or to multiple camera inputs routed via a multiplexer. It is compatible with Bosch and many other brands of multiplexers. The DVR1C allows the recording of both video and audio signals.

## Functions

### Easy access to stored images

One of the main benefits is the easy access to stored images. Search, for instance, by date/time or alarm events, and images are retrieved instantly. To make it even easier to view, store and share recorded data, individual frames or video can be exported to a Compact Flash card at the touch of a button, then transferred to a PC. Video data is stored in M-JPEG format to ensure compatibility across computer platforms.

### Simple to use

The DVR1C is characterized by its ease-of-use. Simple front panel controls, including jog/shuttle playback control, make it extremely easy to navigate through the menu (displayed on a connected monitor), select options as well as view images. Operation is also possible via an optional supplied remote control. An optional cable incorporating an IR sensor enables remote control even if the recorder is out of the line of sight.

### Event-triggered recording

Recording can be triggered by an alarm connected directly to the DVR. All video images pass through a buffer. When an alarm is activated the video footage recorded just prior to the alarm is transferred to the hard disk, allowing users to view events leading up to the alarm at later time. Various recording modes are available, giving users the choice of optimized image quality or longer uninterrupted recording periods.

### Remote access via Internet

For added convenience, the DVR1C incorporates a network facility that allows remote, Internet-based viewing using a standard web browser. Live or stored images can be accessed from any location, without disrupting recording. Users with the appropriate access clearance can even stop or start recording remotely. This is part of the multi-level

password protection, which makes it possible to determine precisely who can view recorded and/or live images.

### Installation/Configuration Notes

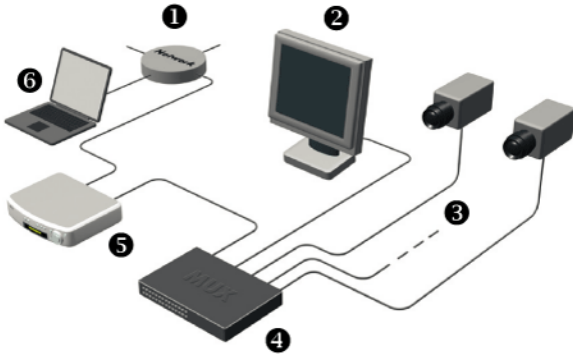

- |           |                                |
|-----------|--------------------------------|
| 1 LAN     | 4 Multiplexer                  |
| 2 Monitor | 5 DVR1C Digital Video Recorder |
| 3 Cameras | 6 PC                           |

### Technical Specifications

#### Electrical

Video Format	PAL / NTSC
Video Input	1 camera input (BNC), 1 Vpp, 75 Ohm
Video Output	1 video output (BNC) for main monitor, 1 Vpp, 75 Ohm
Video Compression	M-JPEG
Video Resolution	720 x 576 (PAL) / 720 x 484 (NTSC)
Video Display	Full display for live and playback
Audio Connectors	2 mono (Line) inputs, 1.6 Vpp 2 mono (speaker) outputs, 1.6 Vpp
Alarm Input	Yes
Alarm Output	Yes (max. 24 Vdc / 2 Adc)
HDD Storage	160 GB
Recording Mode	Continuous, time-lapse, schedule or event recording
Recording Rate	50 images/sec. (PAL) 60 images/sec. (NTSC)
Playback Rate	50 images/sec. (PAL) 60 images/sec. (NTSC)
Playback Search	Date/time, recording list or event(alarm)
Video Loss Detection	Yes
Event Log	Yes
User Interface	Menu-driven
Setup	By on-screen display menu
User Input Device	Front panel keypad, remote control (IR with wired receiver)
Image Export	Built-in Compact Flash slot
Security	Password protection
Power Supply	100 - 240 VAC, 50/60 Hz
Power Consumption	< 40 W
Timer	Weekly timer, built-in real time clock
Network Connection	TCP/IP via Ethernet, RJ45 connector
Control Connection	RS-232, 9-pin D-Sub connector
Dimensions (W X H X D)	346 x 88 x 269 mm / 13.6 x 3.5 x 10.5 inch
Weight	5.2 kg / 11.5 lbs.
Operating Temp.	+0°C to +40°C (+32°F to +104°F)

### Ordering Information

DVR1C1161 Digital Video Recorder 1 channel, PAL/NTSC, 100-240 VAC, 50/60 IPS, 160 GB, NETWORK I/F	DVR1C1161
DVR1C1161U Digital Video Recorder (UK) 1 channel, PAL/NTSC, 100-240 VAC, 50/60 IPS, 160 GB, NETWORK I/F (UK ver- sion)	DVR1C1161U

## Ordering Information

### Accessories

RC283511/01 IR Remote Control For color observation systems, PAL/NTSC	RC283511/01
VSS7914/00T IR Eye Extension Cable for DVR1A, B and C For use with DVR1B1161 or DVR1C1161, 10 m (30 ft), PAL / NTSC	VSS7914/00T

**Europe, Middle East, Africa:**  
Bosch Security Systems B.V.  
P.O. Box 80002  
5600 JB Eindhoven, The Netherlands  
Phone: + 31 40 2577 284  
Fax: +31 40 2577 330  
emea.securitysystems@bosch.com  
www.boschsecurity.com

**Americas:**  
Bosch Security Systems, Inc.  
130 Perinton Parkway  
Fairport, New York, 14450, USA  
Phone: +1 800 289 0096  
Fax: +1 585 223 9180  
security.sales@us.bosch.com  
www.boschsecurity.us

**Asia-Pacific:**  
Bosch Security Systems Pte Ltd  
38C Jalan Pemimpin  
Singapore 577180  
Phone: +65 6319 3450  
Fax: +65 6319 3499  
apr.securitysystems@bosch.com  
www.boschsecurity.com

**Represented by**