

AFM-VD10M2

2 Megapixel Night Vision Indoor Dome IP Camera

High Power LED's enables better night vision performance
Compact slim design with quick & easy installation mechanism



Key Features

- 2 Mega pixel 1/2.8" SONY progressive scan CMOS image sensor for excellent image quality (Exmor)
- 4mm Wide angle Megapixel Board Lens
- 20M IR Beam Distance (4 Built-in High Power LED's)
- Multi Streaming of H.264 and MJPEG
- Supports image resolution up to 1920x1080 (FHD)
- Full HD (1920x1080:1080p) Max. 30fps
- Supports CBR and CVBR modes
- Controllable frame rate
- Privacy Masking up to 8 areas
- Supports WDR, Defog, 2D+3DNR, Smart IR
- Digital PTZ
- Tool-Free 3-Axis
- 12VDC/ IEEE802.3af POE
- Conformant with ONVIF (Profile-S)
- Includes Windows based IP Installer and license-free 16 channel NVR(Network Video Recorder) software
- 1 Port Analog Video Output (CVBS)

Dimensions (Unit :mm)

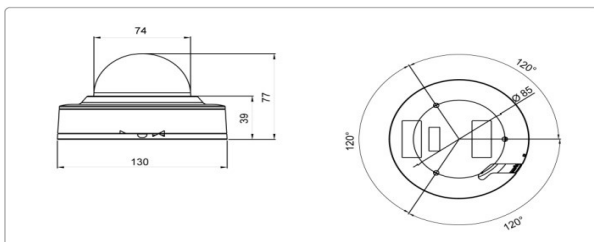

IP Night Vision – Indoor Dome

Specifications

| MODEL | AFM-VD10M2 |
|---------------------------|--|
| System | |
| CPU | 32-bit ARM9 RISC CPU up to 432MHz |
| Flash | 128 Mbyte |
| SDRAM | 128 Mbyte |
| Camera | |
| Image sensor | 2.0 Megapixel 1/2.8" SONY progressive scan CMOS(Exmor) |
| Total Pixels | 1952(H) x 1116(V) 2.18 Megapixel |
| Effective Pixels | 1944(H) x 1104(V) 2.15 Megapixel |
| S/N Ratio | More than 50dB |
| Min. Illumination | 0 Lux (IR On) |
| IR Distance | 20M (4 Built-in Power LED's) |
| Day & Night | ICR |
| Lens | 4.0mm Wide angle Megapixel Board Lens |
| Video | |
| Video compression | H.264 High Profile@4.0, MJPEG-Image quality: 3 Steps |
| Resolutions | Up to 1920 x 1080 (Full HD) |
| Frame rate | H.264 Up to 30fps with 1920x1080 MJPEG Up to 30fps with VGA resolution |
| Video streaming | Support multi stream with H.264, MJPEG, Adjustable frame rate, CVBR/CBR in H.264 |
| Pan/Tilt/Zoom | Digital PTZ |
| Image Setting | Day & Night |
| | Auto White Balance |
| | Auto Exposure |
| | Privacy Mask |
| | WDR(Low/Middle/High) > 120dB |
| Output | Defog(On/Off), Smart IR (Off / 0~15) |
| | 3DNR(On/Off) |
| | Effect - Color, Sharpness, Mirror/V-Flip, etc. |
| Output | CVBS : 1.0 Vp-p / 75Ω composite |
| Alarm In/Out | In: 1, Out: 1 |
| Audio (optional) | |
| Audio Streaming | One Way Audio (Microphone Input/ 1x Live-in (Single mono)) |
| Audio Compression | G.711 |
| System Integration | |
| Security | Password Protection, User access log, HTTPS encryption |
| Supported protocol | HTTP, HTTPS, FTP, SMTP, UPnP, DNS, DDNS, NTP, RTSP, RTP, TCP, UDP, ICMP, DHCP |
| Intelligent video | Motion detection up to 1920x1080 with 4x3 blocks |
| Alarm events | File upload via ftp, E-mail, Notification via email, FTP and TCP |
| Video buffer | 5MB pre-alarm and 180 sec (max) post-alarm |
| Firmware upgrade | Remote upgrade via network |
| API | CGI Interface document, ActiveX Interface(ocx(dll) + document) |
| Physical | |
| Power Source | DC12V/1.5A, PoE(Power over Ethernet): 802.3af-Optional |
| Storage | Micro SD Slot (Built-in) |
| Power Consumption | Max. 6W with IR |
| Net Weight | 280g (Camera only) |
| LED's | Power, Network Connection |
| Dimension | 130mm(Dia.) x77mm |
| General | |
| Operating Temperature | -10 degree~50 degree Celsius(14F~122F) |
| Storage Temperature | -20 degree~60 degree Celsius(-4F~140F) |
| Software | |
| Included Software | NVR C/S (16 Channel), IP Installer (Windows only) |

* Specifications are subject to change without prior notice.